



Gabler processing solutions. **The perfect combination of experience and innovation.**



➤ Through our comprehensive service, we offer strategic advantages in terms of production, safety and quality. **We help our customers continuously improve their processes and achieve global standards.**

For over 115 years, Gabler Engineering has represented the perfect combination of experience and innovation, offering machines and systems for the development, construction and manufacture of complex, tailor-made processing systems for the confectionery, food and pharma industries. The company

provides innovative technology and highly flexible machinery such as extruders, coating machines and spray cabinets. Since 2022 Gabler is part of Coperion. Together, both companies now offer an extensive portfolio and additional services for new and existing customers.

YOUR ADVANTAGES

› Custom-made solutions

Machine design and manufacturing in-house in Germany according to customer requirements

› Flexibility and agile response

In-house production of individual key parts for each project to ensure highest quality and maximum flexibility

› Expertise

We have a qualified team to ensure our high level of quality. We do not subcontract to third parties

› Standards and documentation

All Gabler machine designs and documentation follow the relevant international standards and are certified according to the updated certifications

Gabler machines and systems fulfill the highest hygienic requirements of the food and pharmaceutical industries:

- › All Gabler machines and equipment are certified to meet all specifications in terms of high quality, safety, functionality as well as sustainability
- › Design and manufacturing according to GMP standards
- › Designs with smooth surfaces and removable and modular parts that ensure easy access, cleaning and maintainance
- › Stainless steel AISI 304 materials and parts in contact with product AISI 316L
- › Global recognition for long service life, precision and tailoring to customer specifications
- › Availability of spare parts thanks to in-house manufacturing
- › Machines and systems supplied with validation documents for the pharmaceutical industry (DQ, IQ, OQ)



› OUR SERVICE OFFERINGS:

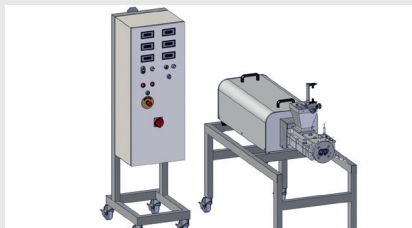

Extrusion Solutions

- › Counter-rotating extruder
- › Co-rotation extruder

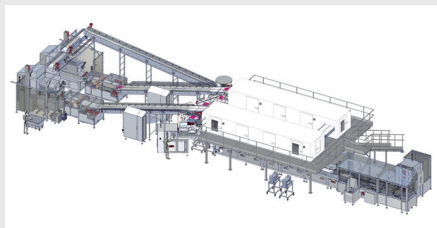

Confectionery Solutions

Production of highly viscous masses:

- › Chewing gum
- › Bubble gum
- › Stick, tab and dragee gum
- › Special gum (layer, cube, center filled and hexagon shaped gum)
- › Powder, liquid-filled balls or hollow balls
- › Chewy candy and toffee



Pharma Solutions

Mixing, re-shaping of pharmaceutical ingredients

- › Viscous masses
- › Hot melt extrusion
- › Pellets
- › Granulation
- › Spheronization



Coating Solutions

- › For chocolate, cereals, nuts and gum products
- › Film coating
- › Hard and soft sugar coating
- › Sugar free coating
- › Suspension coating
- › Seed coating

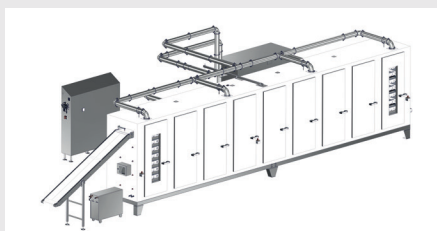

Cooling / Conditioning Tunnels

Our cooling / conditioning tunnels are well insulated all around using the "sandwich system". The modular design allows numerous configurations according to customer requirements and space constraints.



Integration & Service

- › Integration and process automation
- › Process validation and documentation

FULL SERVICE:

Gabler can assist you in all aspects of product development and production:

- › Process integration, optimization and automation
- › Technical assistance
- › Product information
- › Formulation development
- › Tests in our lab or in your facilities
- › Production guidelines
- › Fluid service simulation
- › Process validation and documentation

Gabler Engineering GmbH
Daimlerstrasse 20c
76316 Malsch
Germany

Phone: +49 7246 / 9250-0
Fax: +49 7246 / 9250-54

sales@gablermade.com
www.gablermade.com

Since 2022, Gabler Engineering is
part of Coperion.
For more information please visit:
www.coperion.com

