

Spare parts catalog

Sphero-Diverter valve WEK/WET 55-350

Spare parts catalog number S55926_GB_2008-01

Coperion Waeschle GmbH & Co. KG
Niederbieger Strasse 9
88250 Weingarten / Germany

Telephone +49 (0)751 408 0
Fax +49 (0)751 408 200
www.coperion.com

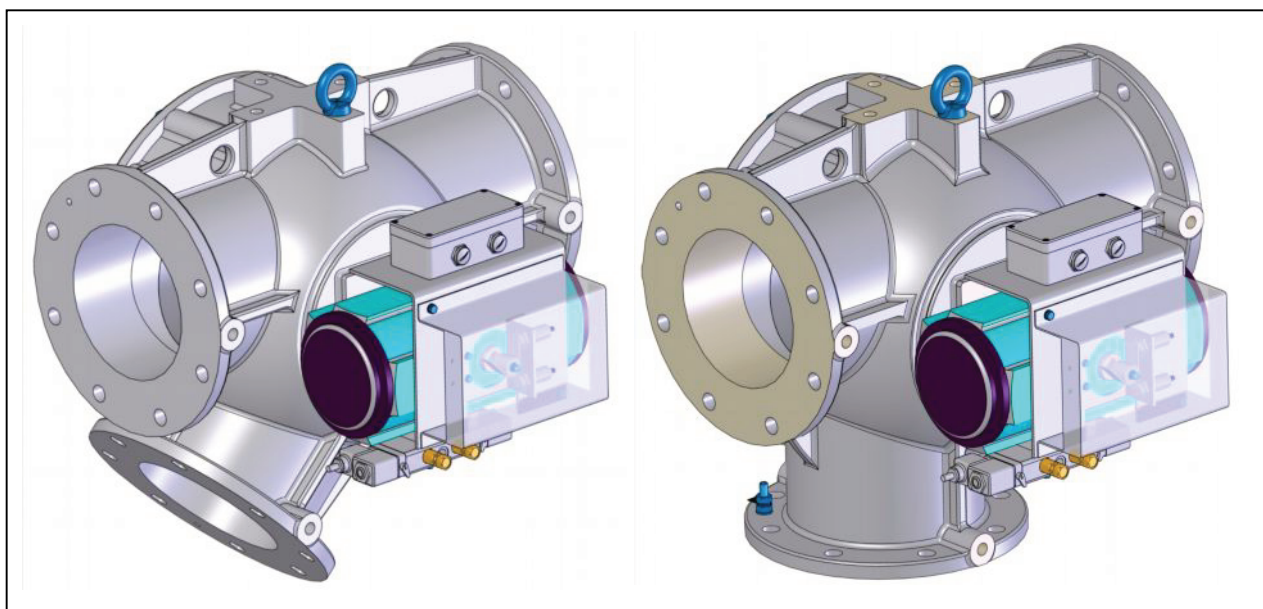

Type / Serial number

**Order no. /
Year of manufacture**

--

--

Coperion Waeschle GmbH & Co. KG

P.O. Box 4065

D-88219 Weingarten

Telephone: +49 / 751 4 08-0

+49 / 751 4 08-450 (service number)

Fax: +49 / 751 4 08-200

© 2008 Coperion Waeschle GmbH & Co. KG • D-88219 Weingarten

All rights reserved, in particular the right of reproduction and distribution as well as translation. No part of these instructions may be reproduced in any form whatsoever (print, photocopy, microfilm or other process) without the written permission of Coperion Waeschle or stored, processed, reproduced or distributed by the use of electronic systems.

Contents of Spare parts catalog

	Number	Chapter
Spare and wearing parts	K55933/GB/01-08	1.0



This Spare parts catalog must only be used in conjunction with Operating Manual M55893, which was supplied with every diverter valve as standard!

- Blank page -

Spare and wearing parts

Contents	Page
1 Stockkeeping of spare parts	2
2 Service	3
3 Spare and wearing parts.....	4
3.1 Drawing of spare parts.....	4
3.2 List of spare parts	5

1 Stockkeeping of spare parts

It is an essential requirement for ensuring the constant function and readiness for operation of the diverter valve that a stock of the most important spare and wearing parts is kept at the site of installation.

Please refer to the spare parts list for ordering spare parts.

The drawings of spare parts are designed to provide further information.

We only guarantee original spare parts supplied by us.

We must point out expressly that original spare parts and accessories not supplied by us have neither been tested nor approved by us. The installation and/or use of such products might therefore have a negative effect on the design properties of the diverter valve, thereby impairing the active and/or passive operational reliability and safety of the unit. Coperion Waeschle does not accept any liability and warranty for damage incurred as a result of the use of non-original spare parts and accessories.



In particular with employment in highly combustible atmosphere (after ATEX) the use of original spare parts is prescribed, in order to ensure the security of the diverter valve.

Please note that there are often special manufacturing and supply specifications for our own and bought-in parts and that we always provide spare parts in line with the state of the art and in accordance with the most recent statutory requirements.

Please quote the following data when ordering spare parts:

Unit data:

- Serial number (shown on rating plate)
- Type designation (shown on rating plate)
- Coperion Waeschle order number with sub-assembly (if applicable)

Spare parts data:

- Operating instructions number (see cover sheet)
- Item
- Designation
- Quantity

2 Service

We recommend a regular service by our qualified technical team. We would like to increase the operability of your components even after prolonged periods of use and can therefore offer you the facilities of our Service Centre.

- We would be pleased to offer you a maintenance contract. This means that we would not only undertake to carry out the actual maintenance work, but also monitor the maintenance cycles etc. This operates very simply: We enter your records in our service computer file and contact you automatically to arrange a convenient date.
- If you would like to carry out the maintenance work yourself, we would be pleased to provide intensive training for your operating personnel with regard to the operation and repair of Coperion Waeschle components. We run courses in our engineering department and our teaching facilities to provide you with comprehensive information about diverter valves and shut-off valves, thereby enabling you to carry out your own maintenance and troubleshooting.
- Naturally we would also be pleased to carry out the assembly and commissioning of your Coperion Waeschle components.

If you require any of these facilities, please contact our Service Centre:

Coperion Waeschle GmbH & Co. KG

P.O. Box 4065

D-88219 Weingarten

Telephone: +49 / 751 4 08-0

+49 / 751 4 08-450 (service number)

Fax: +49 / 751 4 08-200



For safety reasons you should only use original Coperion Waeschle spare parts.

To allow us to deal with your requests quickly and efficiently, we require the following information:

- Serial number (shown on rating plate)
- Type designation (shown on rating plate)
- Coperion Waeschle order number with sub-assembly (if applicable)
- Description of the problem
- Operating data

3 Spare and wearing parts

3.1 Drawing of spare parts

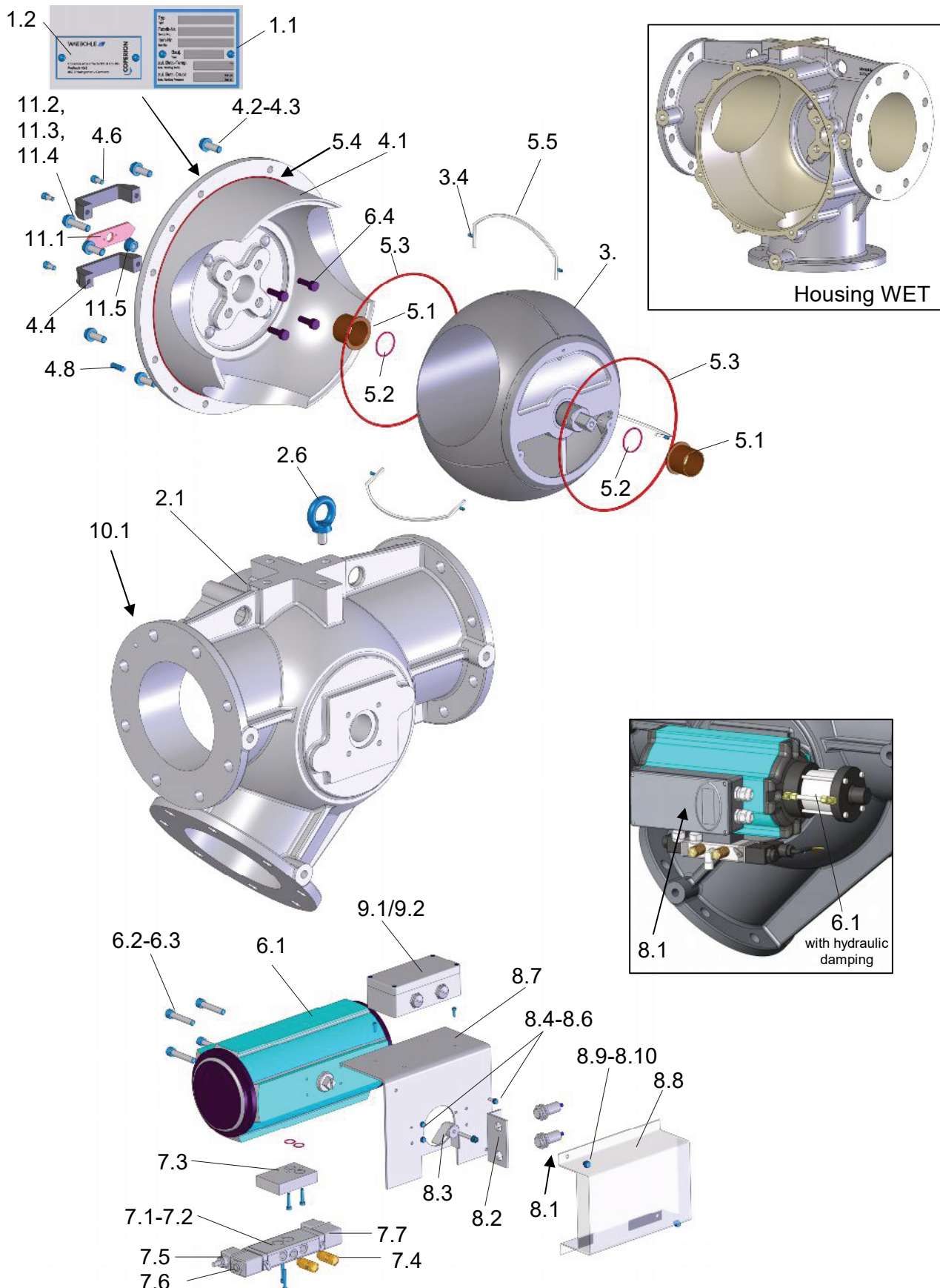

3.2 List of spare parts

Item	Designation	DIN	Quantity/unit	K*
1	Print		1	
1.1	Plate - rating plate		1	
1.2	Plate - nameplate		1	
			1	
2	Housing WEK/WET		1	
2.1	Housing		1	
2.6	Eyebolt	580	1	
3	ROTATING ELEMENT			
3.1	Rotating element WEK/WET (with transverse seal)		1 depending on version	
3.1A	Rotating element WEK/WET (with gap seal)		1 depending on version	
3.4	Set screw (for transverse seal only)	916	6 depending on version	
4	SIDE COVER			
4.1	Cover WEK/WET		1	
4.2	Washer	125	5-10	
4.3	Hexagon bolt	933	5-10	
4.4	Bow-type handle		2	
4.6	Bolt	912	4	
4.8	Parallel pin			
5	BEARING AND SEAL			
5.1	Locating bearing		2	E
5.2	O-ring		2	V
5.3	O-ring		2	V
5.4	O-ring		1	V
5.5	Transverse seal PTFE (only for rotating element 3.1)		3 depending on version	V
6	PNEUMATIC DRIVE		1	
6.1	Rotary actuator		1 depending on version	E
	Rotary actuator with hydraulic damping		1 depending on version	E
6.2	Bolt		4	
6.3	USIT ring		4	V
6.4	Locking bolt			

* E = Spare part; V = Wearing part

Item	Designation	DIN	Quantity/unit	K*
7	SOLENOID VALVE			
7.1	Solenoid valve		1	E
7.2	Solenoid		2	E
7.3	Valve adapter (Namur)		1	
7.4	Outlet regulator		2	E
7.5	Cable		1	
7.6	Plug		1	
7.7	Bracket		1	
8	PROXIMITY SWITCH			
8.1	Proximity switch (mechanical/inductive)		2	E
8.1	Signal box		1	
8.2	Bracket for proximity switch		1	
8.3	Operating cam		1	
8.4	Hexagon bolt M5x16	933	4	
8.5	Hexagon bolt M5x12	933	4	
8.6	Washer	125	4	
8.7	Bracket WEK/WET		1	
8.8	Guard plate WEK/WET		1	
8.9	Hexagon bolt	933	2	
8.10	Washer	125	2	
9	TERMINAL BOX			
9.1	Terminal box		1	
9.2	Bolt	912	2	
10	EARTHING			
10.1	Earthing screw		3	
	Earth mark		3	
11	POSITION INDICATOR			
11.1	Position indicator		1	
11.2	Hexagon bolt	931	1	
11.3	Washer	125	2	
11.4	Hexagon nut	934	1	
11.5	Washer for position indicator		1	

* E = Spare part; V = Wearing part